

# Maßblätter TGW 15 Entfeuchtungsgeräte

*Made in Germany*

in Truhenbauweise mit Wärmerückgewinnung

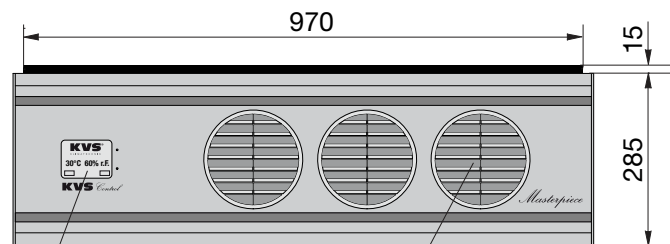
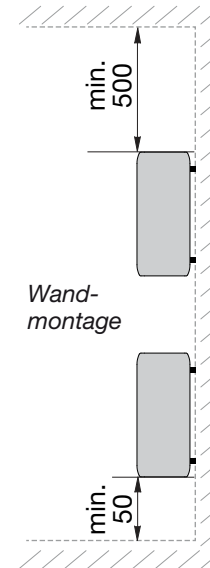
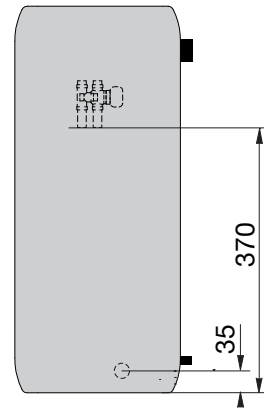
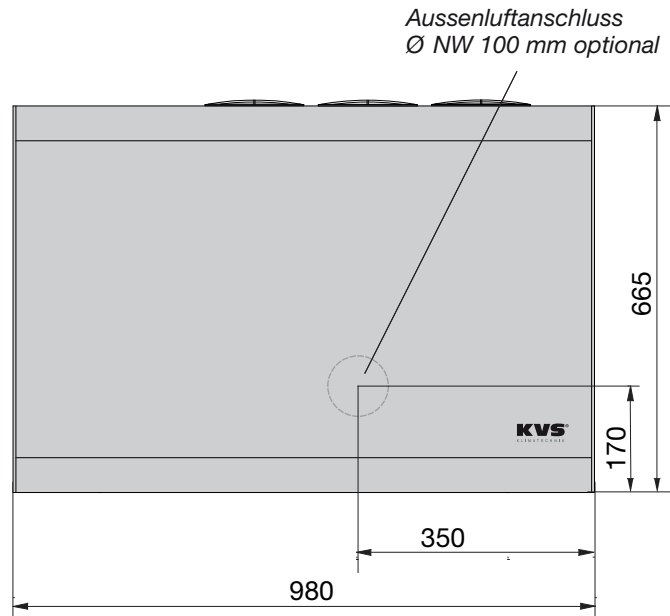

Tauwasser-Ablaufwinkel  
Schlauchanschluss Ø 12 mm (1/2")

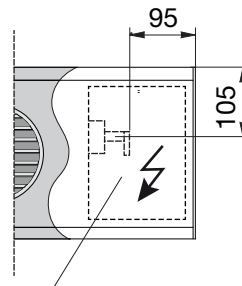

Elektrokabel-  
Bedarf im Gerät ca. 1,5 m

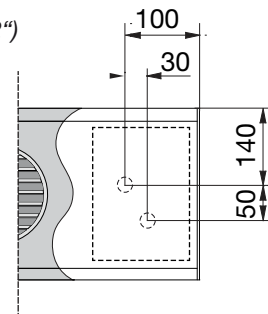

PWW-Heizungsanschluss  
1/2" Aussengewinde